

CARACTERISTICAS / FEATURES

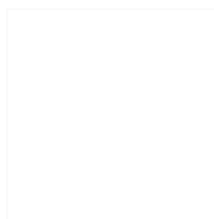

Material hormigón Petra 1
Acabado decapado e hidrofugado
Dimensiones l. 22, a. 17,5, h. 70 cm
Color ver carta de colores
Fijación mediante resina epoxi o con varilla metálica
Peso 39 Kg
Palet 120 x 80 cm (20 un)

Material precast concrete Petra 1
Finish scaled and waterproofed
Dimensions l. 22, w. 17,5, h. 70 cm
Colour see colour catalogue
Fixing with epoxy resin or with metal rod
Weight 39 Kg
Pallet 120 x 80 cm (20 un)

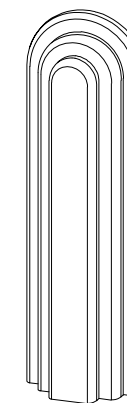

NY

dineñador / design: magourban

GEOMETRIA / GEOMETRY

CON CADENA / WITH CHAIN

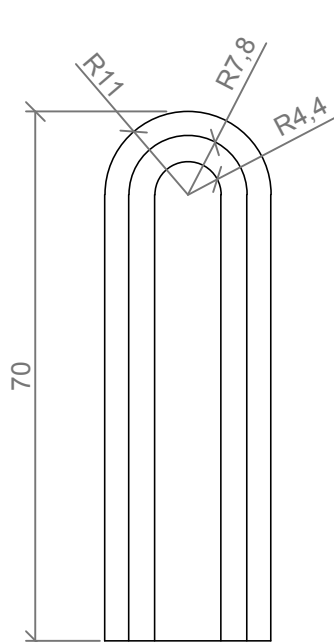

ALZADO / FRONT VIEW

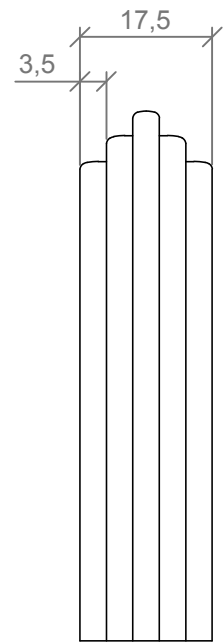

PERFIL / PROFILE VIEW

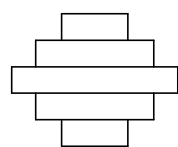

PLANTA / TOP VIEW

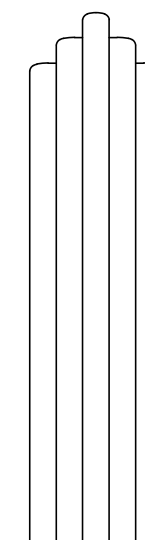
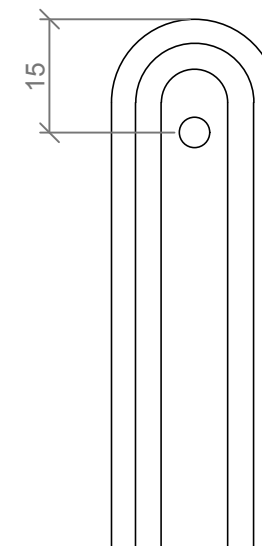

OPCIÓN 1
OPTION 1

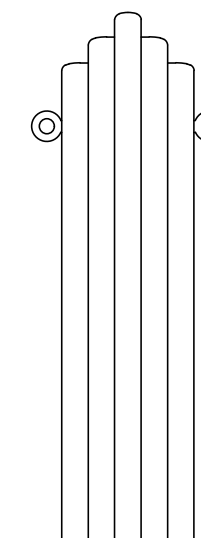
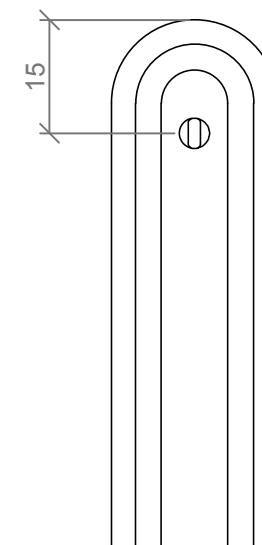

OPCIÓN 2
OPTION 2