

# IDK-1115WP

## 15.6" WXGA Industrial Display kit with PCT Touch Solution

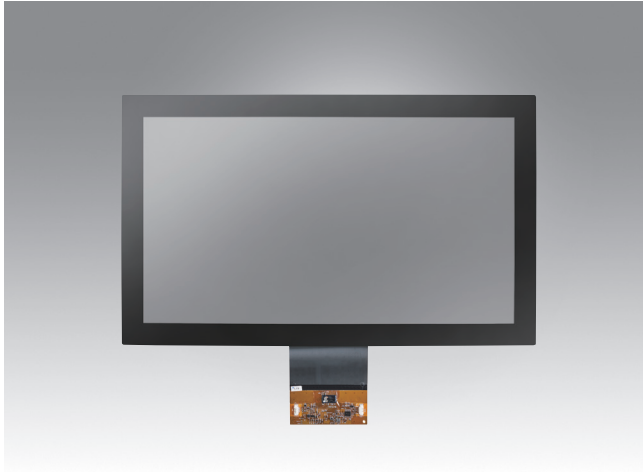

### Features

- 15.6" LCD supports 1366 x 768 pixels
- Brightness of 500 cd/m<sup>2</sup> with LED backlight
- Projected Capacitive touch solution
- High contrast ratio of 600:1
- Wide view angle of 150°/160°
- LVDS signal interface
- Low power consumption 12.1 W (panel only)
- Touch controller included (USB)
- Anti Reflector surface treatment (optional)
- Optical bonding (optional)

### Introduction

The Advantech IDK-1115WP series comes with a 15.6" industrial grade IPS LCD display with Projected Capacitive touch. IDK-1115WP series supports Projected Capacitive touch with low power consumption. IDK-1115WP series is ideal for embedded applications which customers have maximum flexibility for mechanical design.

### Specifications

LCD Panel	Display Size	15.6", 16:10
	Resolution	1366 x 768
	Viewing Angle (U/D/L/R)	150° / 160°
	Brightness	500 cd/m <sup>2</sup>
	Backlight Life (hrs)	50,000 min
	Contrast Ratio	600 : 1
	Response Time	11 ms
	Colors	16.7M
	LCD Input Voltage	5 V
	Consumption	12.1 W
	Signal Interface	LVDS
	Weight	720 g
	Dimensions (W x H x D)	363.80 x 215.98 x 9.30 mm
Touch Screen	Touch Type	Projected Capacitive
	Transparency	87 ± 2%
	Interface	USB
	Surface Treatment	Clear
	Black Print	Yes
Environment	Operating Temperature	-10 ~ 60° C
	Storage Temperature	-20 ~ 60° C

## Dimensions

Unit: mm

### 1115WP-50HDA1E

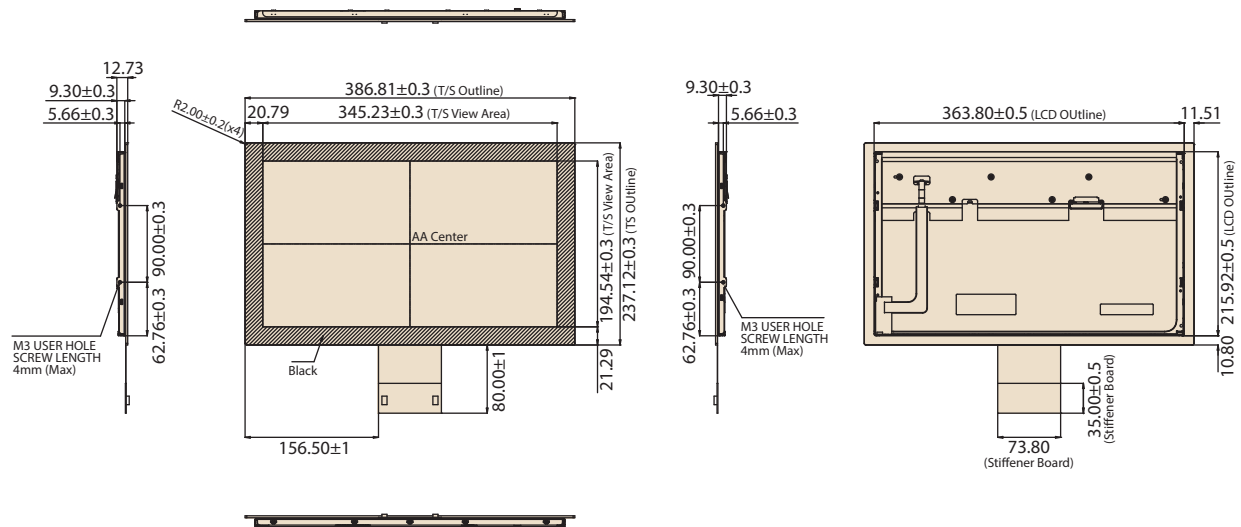

Note: Tolerances unless marked are ±0.5mm

## Ordering Information

Part No.	Size	LCD Brightness (cd/m <sup>2</sup> )	Interface	Touch screen	Touch Interface
IDK-1115WP-50HDA1E	15.6"	500	LVDS	Projected Capacitive Touch	USB

## Packing List

Part Number	Description
1700024808-01	1 x USB Touch cable

Note: Package contents are subject to change without prior notice

## Optional Order

SBC Part No.	LVDS cable P/N	Display interface	B/L cable P/N	Touch interface	Touch power input
MIO-5270	96CB-L3040PAI5	24bit LVDS	96CB-E0505PAC3	USB	5 V
AIMB-270	96CB-L3040PAI5	24bit LVDS	96CB-E0505PAC3	USB	5 V

For more compatible embedded board solution, please visit our Build Your display web page as bellow  
<http://www.advantech.com/buildyourdisplay>