

# NMS030.1.2 SERIES MICRO DIAPHRAGM GAS PUMPS



NMS030.1.2KPDC-B



NMS030.1.2KPDC-B4

## ADVANTAGES

- Customizing available
- Tested to customers specs
- High performance to size, efficiency and weight ratio
- Excellent reliability/durability
- Speed controllable
- Low sound level
- Long service life
- Uncontaminated transfer
- Maintenance-free
- High chemical resistance
- Can be installed in any position

## POSSIBLE AREAS OF USE

- Medical devices
- Analytical equipment
- Emission measurement
- Reprographic
- Degassing
- Safety/Security
- Portable devices

Please visit our website  
[www.knf.com](http://www.knf.com)  
to get more information.

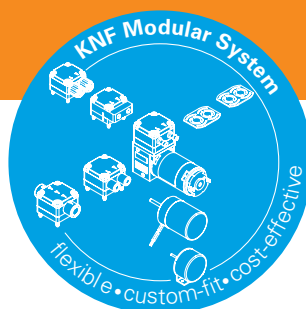

## PERFORMANCE DATA

Series Model	NMS030.1.2			
Material design	KPDC-B		KPDC-B4	
Pump head	PPS			
Diaphragm	EPDM (FKM on request)			
Valves	EPDM (FKM on request)			
Flow rate at atm. pressure (l/min)	10.5	10.5	9.5	12
Ultimate vacuum (mbar abs.)	220	220	220	220
Ultimate pressure (bar rel)	0.2	0.2	0.2	0.2
Permissible media and ambient temperature (° C / ° F)	+5° C to +40° C / 41° F to 104° F (extended temperature on request)			
Weight (g/oz)	218/7.69		218/7.69	

## ELECTRICAL DATA

Voltage (V)	12	24	12	24
Motor	Brushless DC		Brushless DC	
I <sub>max</sub> (A)	0.9	0.55	0.9	0.55

# NMS030.1.2KPDC-B

## PERFORMANCE DATA

Series model	Flow rate at atm. pressure (l/min)	Max. operating pressure (bar rel)	Ultimate vacuum (mbar abs.)
NMS030.1.2KPDC-B 12V	10.5	0.2	220
NMS030.1.2KPDC-B 24V	10.5	0.2	220

## NMS030.1.2KPDC-B

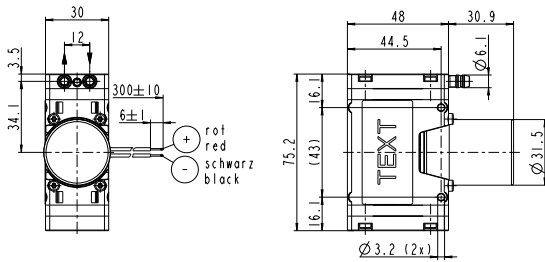

Dimensions in mm

# NMS030.1.2KPDC-B4

## PERFORMANCE DATA

Series model	Flow rate at atm. pressure (l/min)	Max. operating pressure (bar rel)	Ultimate vacuum (mbar abs.)
NMS030.1.2KPDC-B4 12V	9.5	0.2	220
NMS030.1.2KPDC-B4 24V	12	0.2	220

## NMS030.1.2KPDC-B4

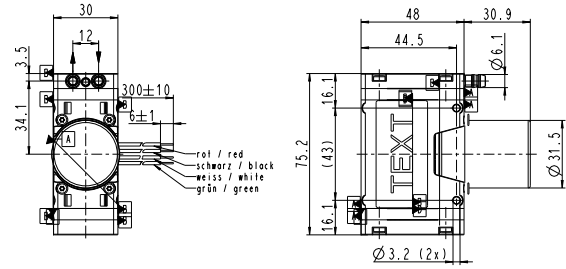

Dimensions in mm

## NMS030.1.2KPDC-B 12V FLOW CURVE

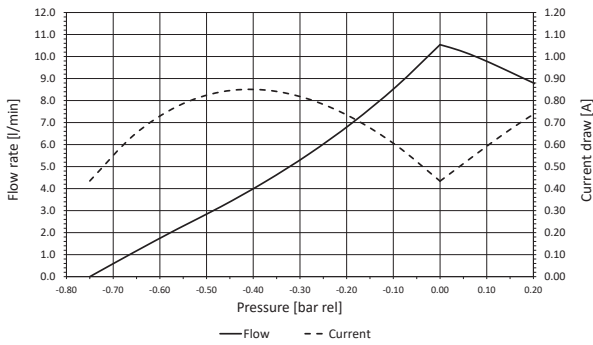

## NMS030.1.2KPDC-B4 12V FLOW CURVE

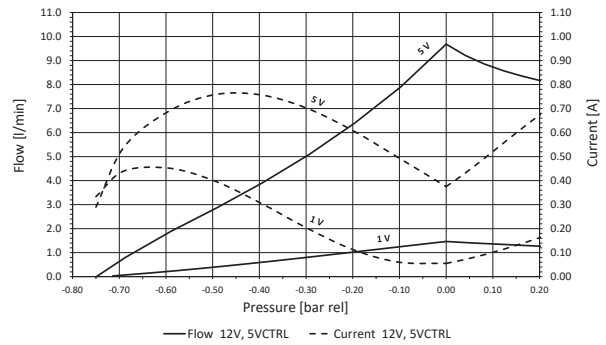

## NMS030.1.2KPDC-B 24V FLOW CURVE

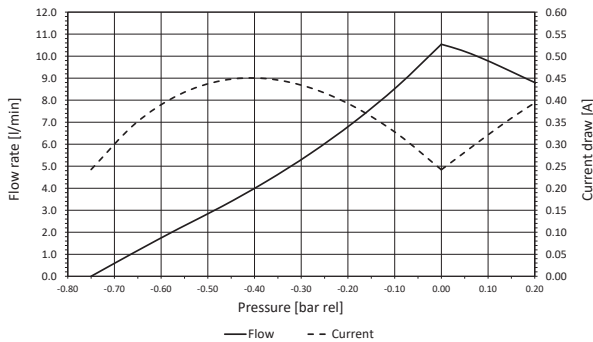

## NMS030.1.2KPDC-B4 24V FLOW CURVE

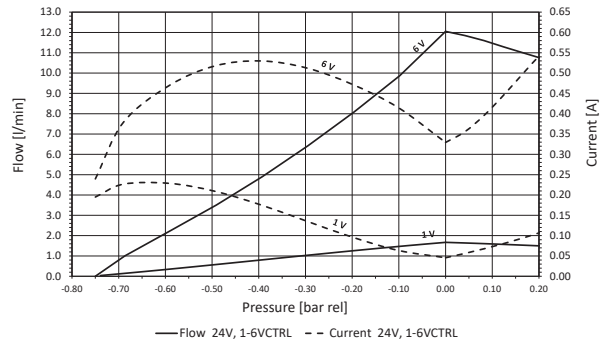

OPTIONS			
Description	Illustration	Part No.	Details
Motors		On request	Other motor options are available. Ask your KNF sales contact to find the best solution for you.

ACCESSORIES			
Description	Illustration	Part No.	Details
Silencer		311970	For hose barbs
Rubber-bonded metal		On request	

The performance values for the series models shown on this data sheet were determined under test conditions. The actual performance values may differ and depend in particular on the usage conditions and therefore on the specific application, on the parameters of the components involved in the user's system and on any technical modifications carried out which deviate from the standard configuration or the as delivered condition.

If individual designs have been created for specific customers on the basis of series models, other technical performance data may apply. Before operation begins, the relevant operating instructions and/or assembly or installation instructions should be read and the safety information contained in these instructions should be noted. KNF reserves the right to make changes to the product and the associated documentation without prior notice to the customer.



[www.knf.com](http://www.knf.com)